

3m.
American Forest Management letter report on a
significant tree inventory
October 28, 2013

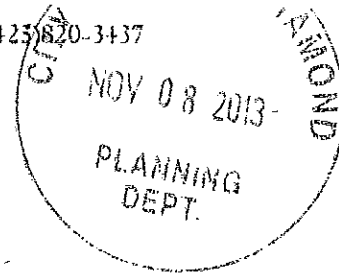

American Forest Management letter
report on a significant tree inventory,
October 28th, 2013.

11115 NE 128th St Suite 110 Kirkland WA 98034 • (+25)820-3420 • FAX (+25)820-3437
www.americanforestmanagement.com



October 28th, 2013

Mr. Colin Lund
Yarrow Bay Holdings
10220 NE Points Drive, Suite 310
Kirkland, WA 98033

RE: The Villages MPD Phase 2 Plat C Preliminary Plat Application

Dear Mr. Lund:

At your request, we have completed an inventory of significant trees within the Villages MPD Phase 2 Plat C Preliminary Plat (approximately 136 acres). The tree inventory area included the area to be developed, and the park area (41.14 acres). The following report summarizes the tree data collected which will be used to comply with the the City of Black Diamond's tree mitigation requirements. The field work was completed by Kelly Wilkinson and Jesse Saunders on October 25th, 2013.

The tree inventory area is comprised of 41.14 acres. All species over 6" DBH (diameter at 4.5' above ground), were inventoried on sample plots, even though some species present are not considered "significant" under city code. One of these non-significant species, red alder, exists in minor numbers on the property. In the summary table that follows, red alder is not included. Please refer to the cruise reports at the end of this report for non-significant tree information.

In this report I've included a copy of the clearing limits map showing the area and acreage that was surveyed, a map of the plot locations and a table showing the species, diameter and count of significant trees.

Stand Description

The forest stand is comprised primarily of planted Douglas-fir, with a minor component of volunteer red alder, big leaf maple, red cedar and western hemlock. The average DBH is 14" with a tree per acre count of significant species of 193. The estimated total significant tree count is 7,969 trees. Scattered infections of laminated root rot were found throughout the stand.

The forest cover primarily consists of sword fern, vine maple, salmonberry, Oregon grape and salal. There are some invasive species present, herb Robert, Scotch broom and English holly.

Inventory Methodology

The subject area was inventoried using fixed plot sampling. The inventory software used was "Superace Timber Cruising Software", which is the industry standard. Inventory plots were established at a rate of approximately one plot per one acre. A total of 42 plots were sampled in 41.14 acres of forest cover. The plot sizes were 1/50th acre. The plot radius size was chosen to sample an average of five trees per plot. A target sampling error of 7.5% at one standard deviation was desired to get an accurate estimate of trees per acre over the entire project area. See the attached cruise map for plot locations.

Summary Tables

The following tables indicate the number of trees per acre by species and diameter classes. Significant trees were broken out into diameter classes per Black Diamond City code (6"-9") (10"-12") (13"-16") (>17"). Non-significant tree species are not included in the summary table.

Tree Summary (Trees per Acre)

Species	6" - 9"	10" - 12"	13" - 16"	17" +	Total
Douglas-fir	21	41	92	37	191
Western Hemlock			1		1
Total	21	41	93	37	193

(Handwritten initials)

Sampling Error

The tree per acre sampling error was computed at 6.4% at one standard deviation for the inventory. This means that 68.1 times out of 100 the actual tree per acre count will be within 6.4%. The other 32 times out of 100 the actual tree count will be above 6.4%. At 2 standard deviations, the sampling error is 10.4%. This means that 95.3 times out of 100, the actual tree count will be within 12.8%.

Please call if you have any questions or if I can be of further assistance.

Sincerely,

Kelly Wilkinson

Forester | American Forest Management, Inc.

Tel: (425) 820-3420 | Email: kelly.wilkinson@amforem.biz

Enclosures:

- Orthophoto Plot Vicinity Map
- Orthophoto Plot Location Map
- Topography Plot Location Map

- Superace Cruising Reports
- Stand Table Summary
- Type Statistics

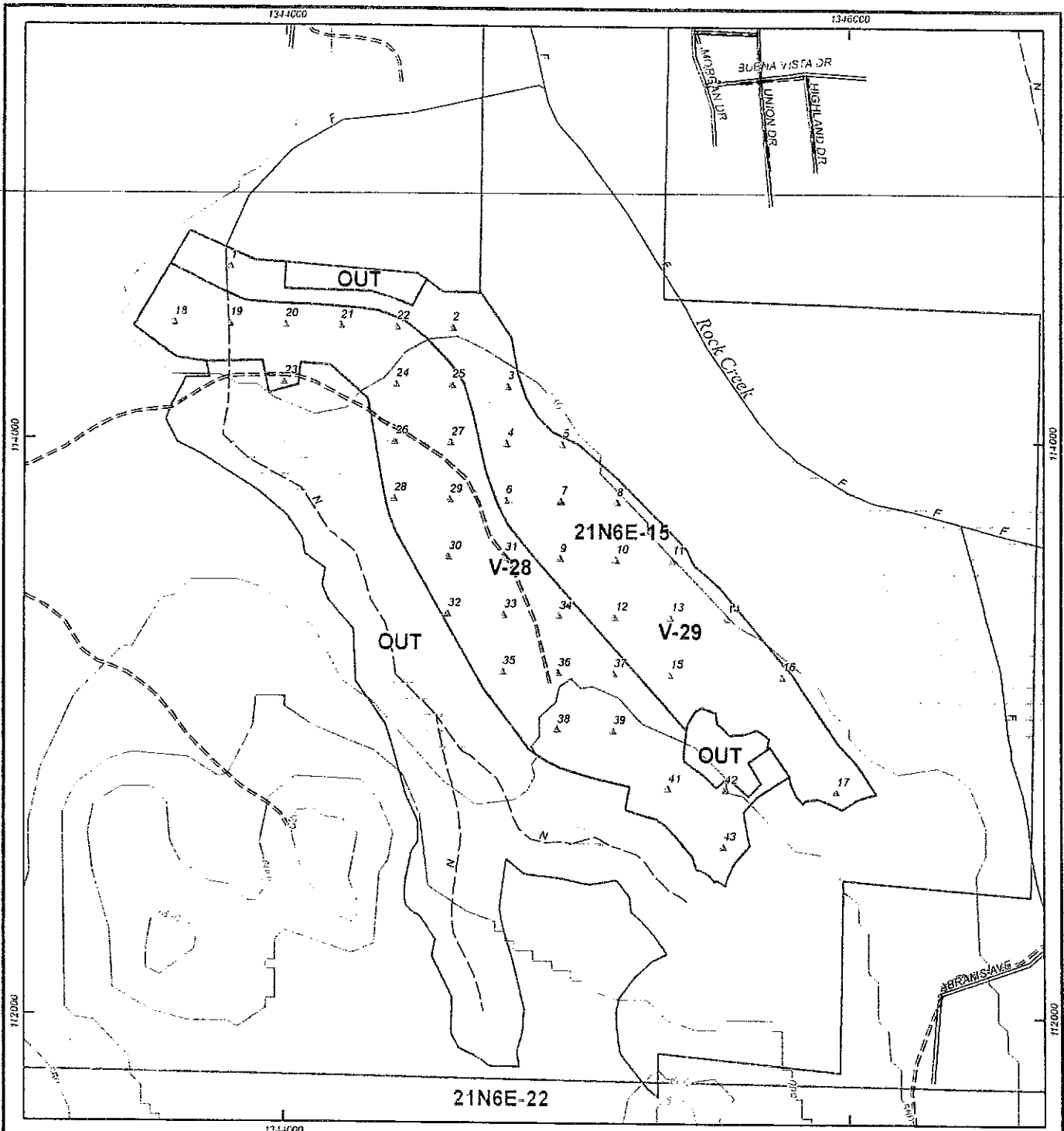

▲	Plot
	V-28; V-29
	OUT
---	20' contour

Project boundaries are approximate

Coordinate system: WA State Plane, North, feet, NAD83

Cruise Notes

Number of plots: 3x3 ch grid

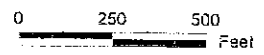

1 inch = 500 feet



American Forest Management, Inc.
 424 3rd St SE, Everett, WA 98203

The Villages V-28 and V-29 Cruise Map
 Sec 15 - T 21 N, R 6 E, King County

TC PSTATS		PROJECT STATISTICS							PAGE	1
Yarrow Bay		PROJECT		V28 V29		DATE		11/4/2013		
TWP	RGE	SC	TRACT	TYPE		ACRES	PLOTS	TREES	CuFt	BdFt
21N	06E	15	BD	V28		41.14	42	163	S	W
21N	06E	15	BD	V29						
		PLOTS	TREES	TREES PER PLOT	ESTIMATED TOTAL TREES	PERCENT SAMPLE TREES				
TOTAL		42	163	3.9						
CRUISE		41	163	4.0	7.969	2.0				
DBH COUNT										
REFOREST COUNT										
BLANKS		1								
100 %										
STAND SUMMARY										
	SAMPLE TREES	TREES /ACRE	AVG DBH	BOLE LEN	REL DEN	BASAL AREA	GROSS BF/AC	NET BF/AC	GROSS CF/AC	NET CF/AC
DOUG FIR	161	191.3	14.0	17	55	205.0				
WHEMLOCK	1	1.2	14.0	17	0	1.3				
R ALDER	1	1.2	9.0	17		.5				
TOTAL	163	193.7	14.0	17		206.7				
CONFIDENCE LIMITS OF THE SAMPLE										
68.1 TIMES OUT OF 100 THE VOLUME WILL BE WITHIN THE SAMPLE ERROR										
CL	68.1	COEFF	SAMPLE TREES - BF				# OF TREES REQ		INF. POP.	
SD:	1.0	VAR. %	S.E. %	LOW	AVG	HIGH	5	10	15	
DOUG FIR										
WHEMLOCK										
R ALDER										
TOTAL										
CL	68.1	COEFF	SAMPLE TREES - CF				# OF TREES REQ		INF. POP.	
SD:	1.0	VAR. %	S.E. %	LOW	AVG	HIGH	5	10	15	
DOUG FIR										
WHEMLOCK										
R ALDER										
TOTAL										
CL	68.1	COEFF	TREES/ACRE				# OF PLOTS REQ		INF. POP.	
SD:	1.0	VAR. %	S.E. %	LOW	AVG	HIGH	5	10	15	
DOUG FIR	42.8	6.6	179	191	204					
WHEMLOCK	648.1	99.9	0	1	2					
R ALDER	648.1	99.9	0	1	2					
TOTAL	41.2	6.4	181	194	206	68	17	8		
CL	68.1	COEFF	BASAL AREA/ACRE				# OF PLOTS REQ		INF. POP.	
SD:	1.0	VAR. %	S.E. %	LOW	AVG	HIGH	5	10	15	
DOUG FIR	43.7	6.7	191	205	219					
WHEMLOCK	648.1	99.9	0	1	3					
R ALDER	648.1	99.9	0	1	1					
TOTAL	42.6	6.6	193	207	220	73	18	8		
CL	68.1	COEFF	NET BF/ACRE				# OF PLOTS REQ		INF. POP.	
SD:	1.0	VAR. %	S.E. %	LOW	AVG	HIGH	5	10	15	
DOUG FIR										
WHEMLOCK										
R ALDER										
TOTAL										
CL	68.1	COEFF	NET CUFT FT/ACRE				# OF PLOTS REQ		INF. POP.	
SD:	1.0	VAR. %	S.E. %	LOW	AVG	HIGH	5	10	15	
DOUG FIR										

TC PSTATS
Yarrow Bay

PROJECT STATISTICS

PAGE 2
DATE 11/4/2013

PROJECT V28 V29

TWP	RGE	SC	TRACT	TYPE	ACRES	PLOTS	TREES	CuFt	BdFt	
21N	06E	15	BD	V28	41.14	42	163	S	W	
21N	06E	15	BD	V29						
CL	68.1		COEFF		NET CU FT FT/ACRE		# OF PLOTS REQ	INF POP		
SD:	1.00		VAR.	S.E.%	LOW	AVG	HIGH	5	10	15
WHEMLOCK										
R ALDER										
TOTAL										